

Ruote Adottate per Serie L-A nelle varie tipologie di Diametri, Battistrada.
Wheels used for L-A series in the various types of diameters and tyres.

Ruota tipo Wheel type				SR	N	
Catteristiche del Battistrada Tyre characteristics				Gomma Sintetica Synthetic Rubber	Nylon	
Durezza del Battistrada conforme UNI EN 12527 Tyre hardness in compliance with UNI EN 12527		shore A		-	>	
Temperature di Utilizzo Raccomandate Recommended working temperatures		Max-		+60°C	+40°C	
		Min-		-10°C	0°C	
Catteristiche del Nucleo Wheel centre characteristics				Polipropilene Polypropylene	Nylon Nylon	
Catteristiche del Mozzo Hub characteristics				Foro Liscio Plain Bearing	Foro Liscio Plain Bearing	

= Peso per 1 pezzo
 = Weight for a piece

Portata Dinamica conforme UNI EN 12527 Dynamic load capacity conform UNI EN 12527	D	Resistenza al Rotolamento (FR) alla Portata Nominale Rolling resistance (FR) at rated capacity	FR
Portata Statica conforme UNI EN 12527 Static load capacity conform UNI EN 12527	S	Resistenza al Superamento Ostacolo (FO) alla Portata Nominale H ostacolo=1% ø della Ruota Min 0.5 mm Obstacle overcoming resistance (FO) at rated capacity Obstacle H=1% of wheel, min.0.5 mm	FO

ITEM	30LN	36LN
A	30	36
D	25	30
S	37	45
FR	0.6	1.0
FO	5.2	5.4
	7	12
€	-	-
ITEM	36LSR	36LN
A	36	36
D	30	30
S	45	45
FR	0.6	1.0
FO	3.5	5.4
	14	12
€	-	-

Gamma di Fissaggi Standard per Supporti Serie L-A
Range of Standard Fixings for Supports of L-A series forks

A Foro Passante ø8.2 per Vite di Fissaggio Imbus M8x20 (*) With bolt hole of ø8.2 for fixing screw imbus M8x20(*)	A Perno Zigrinato Rivettato With riveted knurled stem	Riduttore alettato assemblato Assembled finned reduction unit	A Perno Filettato Rivettato With riveted thread stem	Fissaggio a Piastra Integrale P4 42x42 Integral Plate type fixing P4 42x42																		
O	L	A+ Riduttore Alettato Assemblato Assembled finned reduction unit	F	P4																		
		<table border="1"> <tr> <td>ITEM</td> <td>14</td> <td>16</td> <td>18</td> <td>20</td> <td>22</td> </tr> <tr> <td>øA</td> <td>ø14</td> <td>ø16</td> <td>ø18</td> <td>ø20</td> <td>ø22</td> </tr> <tr> <td>€</td> <td>-</td> <td>-</td> <td>-</td> <td>-</td> <td>-</td> </tr> </table>	ITEM	14	16	18	20	22	øA	ø14	ø16	ø18	ø20	ø22	€	-	-	-	-	-		
ITEM	14	16	18	20	22																	
øA	ø14	ø16	ø18	ø20	ø22																	
€	-	-	-	-	-																	

Requisiti Ruote Serie A nelle varie tipologie di: Diametri, Battistrada, Organi di Rotolamento
 Wheels series A Requirements in the various types of :Diameter, Tyre, Rolling parts

Ruota tipo Wheel type	38	43	45	40SF	40SF/G	50SF	50SF/G	= Peso per 1 pezzo = Weight for a piece
Catteristiche del Battistrada Tyre characteristics	Polipropilene Polypropylene			Gomma Sintetica Synthetic Rubber		Polipropilene Polypropylene	Gomma Sintetica Synthetic Rubber	
Durezza del Battistrada conforme UNI EN 12527 Tyre hardness in compliance with UNI EN 12527	shore A >90			68			68	
Temperature di Utilizzo Raccomandate Recommended working temperatures	Max- +60°C Min- -10°C			+40°C 0°C		+60°C -10°C	+40°C 0°C	
Catteristiche del Nucleo Wheel centre characteristics	Polipropilene Polypropylene							
Catteristiche del Mozzo Hub characteristics					Foro Liscio Plain Bearing	Foro Liscio Plain Bearing		

Portata Dinamica conforme UNI EN 12527 Dynamic load capacity conform UNI EN 12527	D	Resistenza al Rotolamento (FR) alla Portata Nominale Rolling resistance (FR) at rated capacity	FR
Portata Statica conforme UNI EN 12527 Static load capacity conform UNI EN 12527	S	Resistenza al Superamento Ostacolo (FO) alla Portata Nominale H ostacolo=1% Ø della Ruota Min 0.5 mm Obstacle overcoming resistance (FO) at rated capacity Obstacle H=1% of wheel, min.0.5 mm	FO

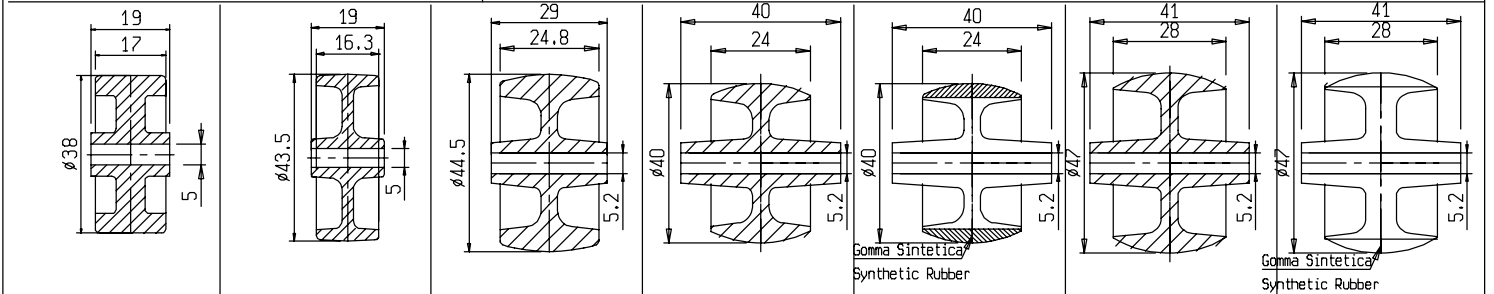

ITEM	38A	ITEM	43A	ITEM	45A	ITEM	40SF	ITEM	40SF/G	ITEM	50SF	ITEM	50SF/G
D		D		D		D		D		D		D	
S		S		S		S		S		S		S	
FR		FR		FR		FR		FR		FR		FR	
FO		FO		FO		FO		FO		FO		FO	
code	11	code	13	code	19	code	14	code	18	code	22	code	23

Gamma di Fissaggi Standard per Supporti Serie A
 Range of Standard Fixings for forks of the A series

A Foro Passante Ø8.2 per Vite di Fissaggio Imbus M8x20 (*) With bolt hole of Ø8.2 for fixing screw imbus M8x20(*)	A Foro Passante Ø8.2 per Vite di Fissaggio Imbus M8x20 (*) With bolt hole of Ø8.2 for fixing screw imbus M8x20(*)	A Perno Filettato Rivettato Dimensioni a Tabella da Specificare sempre all Ordine With riveted thread stem, dimensions as per table to be specified when placing order	Fissaggio a Piastra Integrale P3 37x37 Integral Plate fixing P4 42x42
O	B	F	P3

Fissaggio a Piastra Integrale P4 42x42 Integral Plate fixing P4 42x42	A Perno Zigrinato Rivettato With riveted knurled stem	Riduttore Alettato assemblato Assembled finned reduction unit												
P4	L	A+ Riduttore Alettato Assemblato Assembled finned reduction unit												
		<table border="1"> <tr> <td>ITEM</td> <td>14</td> <td>16</td> <td>18</td> <td>20</td> <td>22</td> </tr> <tr> <td>ØA</td> <td>Ø14</td> <td>Ø16</td> <td>Ø18</td> <td>Ø20</td> <td>Ø22</td> </tr> </table>	ITEM	14	16	18	20	22	ØA	Ø14	Ø16	Ø18	Ø20	Ø22
ITEM	14	16	18	20	22									
ØA	Ø14	Ø16	Ø18	Ø20	Ø22									